

TACO

DATE: FEBRUARY, 1969
SUPERSEDES: 300-2
Dated October, 1967

old

A. I. A. FILE NO. 30-C-5

**NO. 1700
SERIES PUMPS**
FORMERLY NO. 170 SERIES

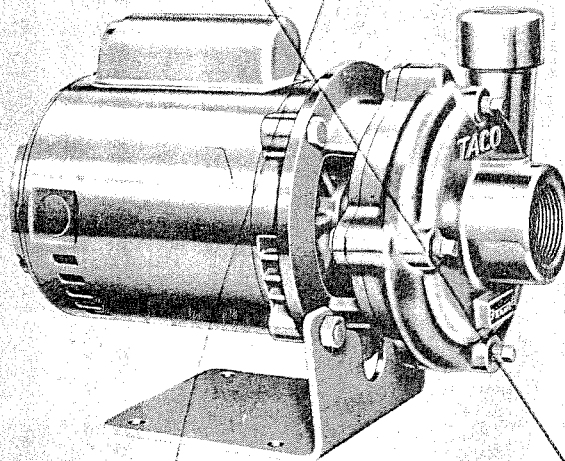

index		
introduction	a	2
performance curves	b	3
specifications	c	4
dimensions	c	1.7

TACO, INC.

CRANSTON, RHODE ISLAND, 02920

TACO HEATERS OF CANADA, LTD.

COOKSVILLE, ONTARIO, CANADA



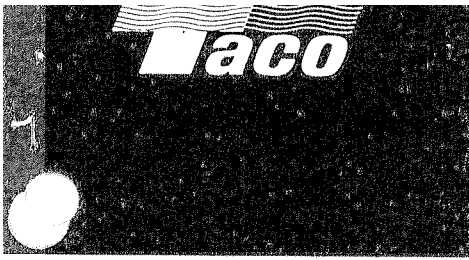

330-2

Purpose

Designed for diversified pumping applications, such as:

- | | |
|----------------------|------------------------------|
| Air Conditioning | Dry Cleaning Plants |
| Auto Laundries | Golf Courses |
| Booster Service | Hotels & Institutions |
| Bottle Washers | Hot & Cold Water Circulation |
| Canneries | Jacket Water Cooling |
| Cooling Towers | Lawn Sprinklers |
| Commercial Buildings | Laundry Equipment |
| Dairies | Livestock Watering |
| Dish Washers | Swimming Pools |

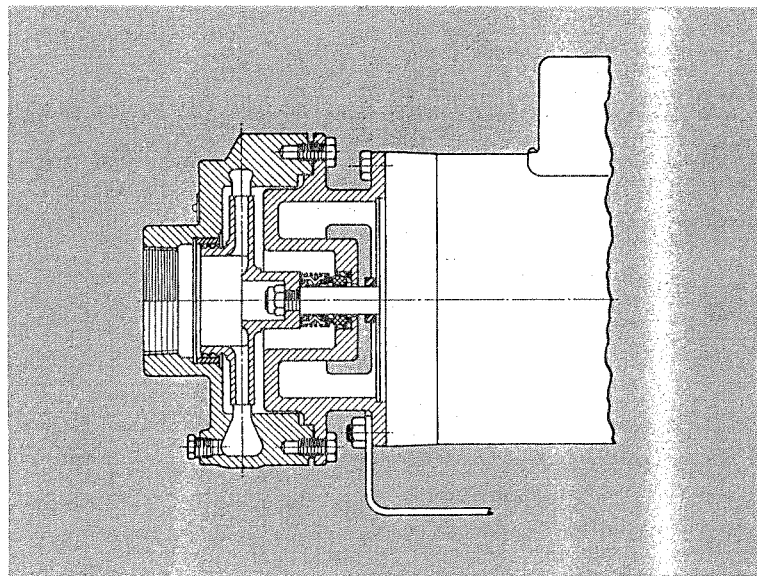

Features

- ◆ Compact — Close Coupled design
- ◆ Mounting — Any position
- ◆ Mechanical Seal — Leak-proof, 2 part, easily replaceable
- ◆ Casing Wear Rings — Bronze — replaceable
- ◆ Impeller — Bronze — Cast in one piece for longer life
- ◆ Motors — Choice of types — permanently lubricated

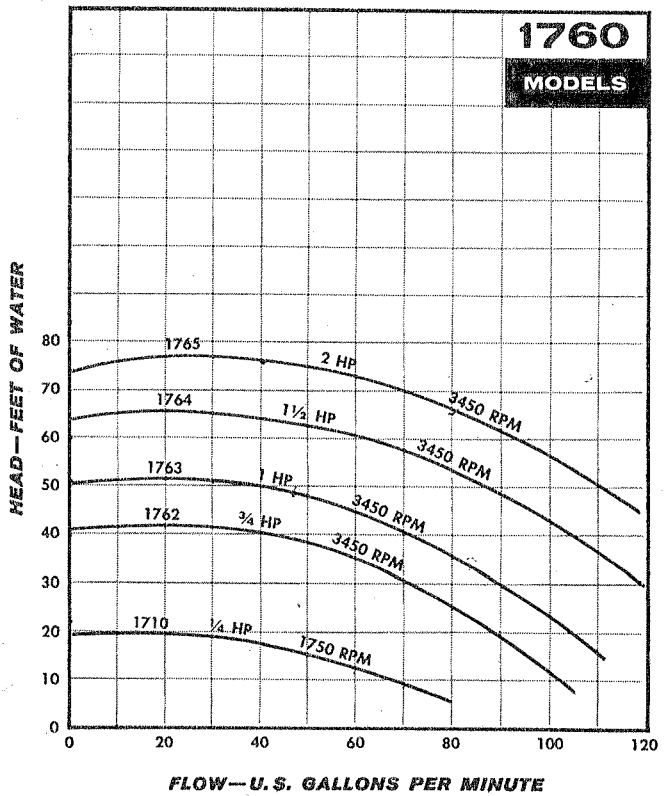
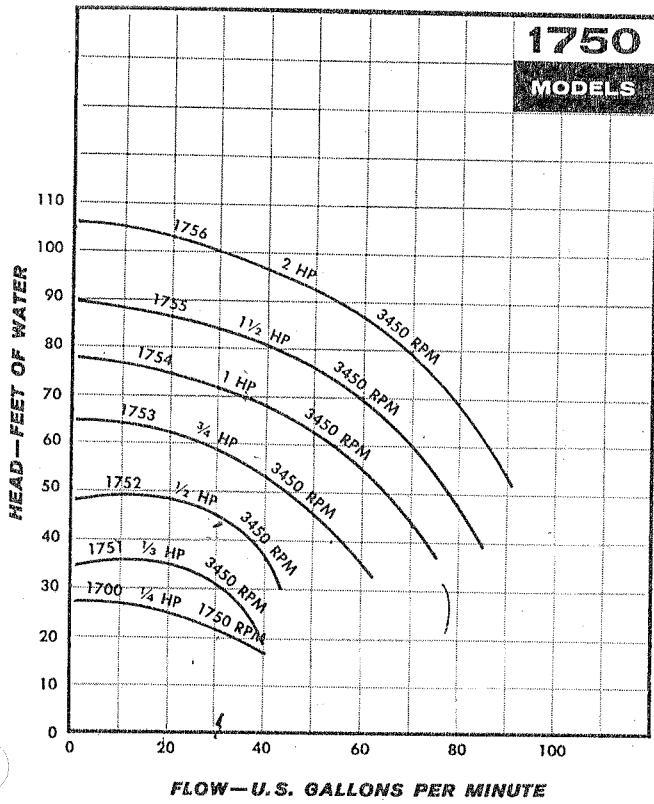

NO. 1700 SERIES PUMPS



Specifications

1. **Motors** - 1750 or 3450 RPM, 200 or 230/460v - 60C - 3 Ph. Ball Bearing, Drip Proof furnished as standard. Single Phase 115/230v - 60C thru 2HP are also available.
2. **Mechanical Seals** - Self-adjusting and self-lubricating.
3. **Impellers** - Bronze - closed type - mechanically and hydraulically balanced.
4. **Shafts** - Stainless Steel.
5. **Casings** - Cast Iron with replaceable bronze wear rings. Also available in bronze at extra cost. Suction and Discharge connections are threaded. Most models (See dimension table) have centerline discharge for automatic air venting.
6. **Mounting** - Pumps are equipped with heavy steel angle bases for Foot Mounting.
7. **Operating conditions** - Temperature - with Permalife no. 1 seal to 250° F. With Permalife no. 2 seal to 275° F. Maximum working pressure - 125 PSIG.

Sizes and Dimensions

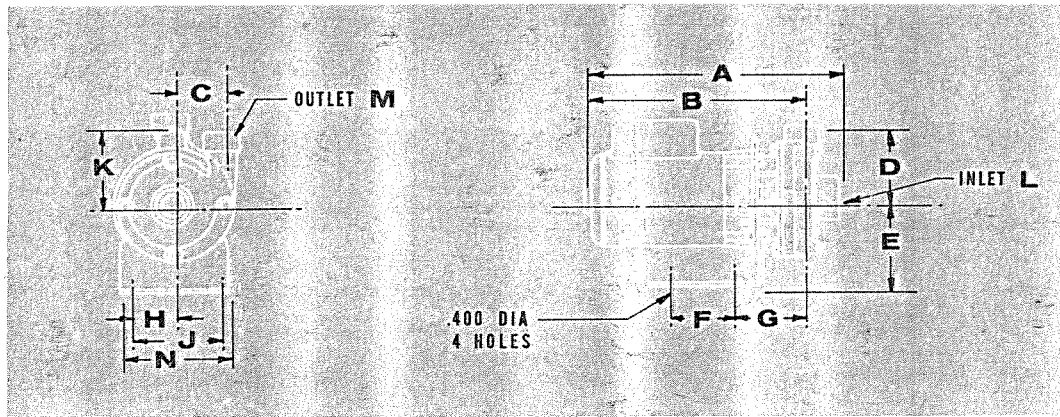

Product No.		Motor HP (2)		A	B	C	D	E	F	G	H	J	K	SUCT. NPT	DIS. NPT	N	SHAFT	DISCHARGE LOCATION	MOUNTING	APPR. SHIP. WHT. LBS.
		200 or 230/460V 3 Ph. Ball Bearing Open Drip Proof Motors	3450 RPM																	
Current (1)	Former	1750 RPM	3450 RPM																	
1700	178	1/4		13 3/8	11 1/8	3	4						4 3/8	1 1/2	1 1/4					44
1751	171		1/3	13 1/8	9 3/8	2 3/4	4						4 3/8	1 1/4	1					34
1752	172		1/2	14 1/8	11 1/8	2 3/4	4	4 3/4	3 3/4	4 1/8	2 1/2	5	4 3/8	1 1/2	1 1/4	6	Stainless Steel	Tangential	Heavy Steel Angle Base	36
1753	173		3/4	14 3/8	11 3/8	3	4						5 3/8	1 1/2	1 1/4					50
1754	174		1	15 3/8	12 3/8	3	4						5 3/8	1 1/2	1 1/4					56
1755	175		1 1/2	16 3/8	14 1/8	3	4						5 3/8	1 1/2	1 1/4					64
1756			2	16 3/8	14 1/8	3	4						5 3/8	1 1/2	1 1/4					68
1710		1/4		12 1/8	10 1/8		6 1/2						4 3/8							47
1762			3/4	14 3/8	11 3/8		6 1/2						5 3/8							49
1763			1	14 3/8	12 3/8		6 1/2	4 3/4	3 3/4	4 1/8	2 1/2	5	5 3/8	2	2	6	Stainless Steel	Center Line	Heavy Steel Angle Base	52
1764			1 1/2	15 11/8	13 1/8		6 1/2						5 3/8							55
1765			2	16 1/4	14 1/8		6 1/2						5 3/8							66

(1) When ordering all bronze, add "B" at end of product number.

(2) Also available with overload protected single phase motors when specified. Starting switches with overload protection must be installed with all 3 ph. motors.

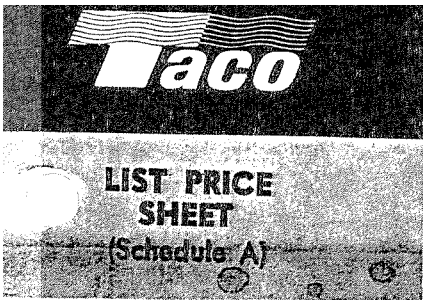

NUMBER

300-2PL-2

REPLACEMENT PARTS
FOR
No. 1720-1730-1770-1780 Series

EFFECTIVE: FEBRUARY 11, 1974
SUPERSEDES: 300-2RL-2 dated 9/1/70

FOR LIST PRICES, REFER TO SHEET 300-2RL

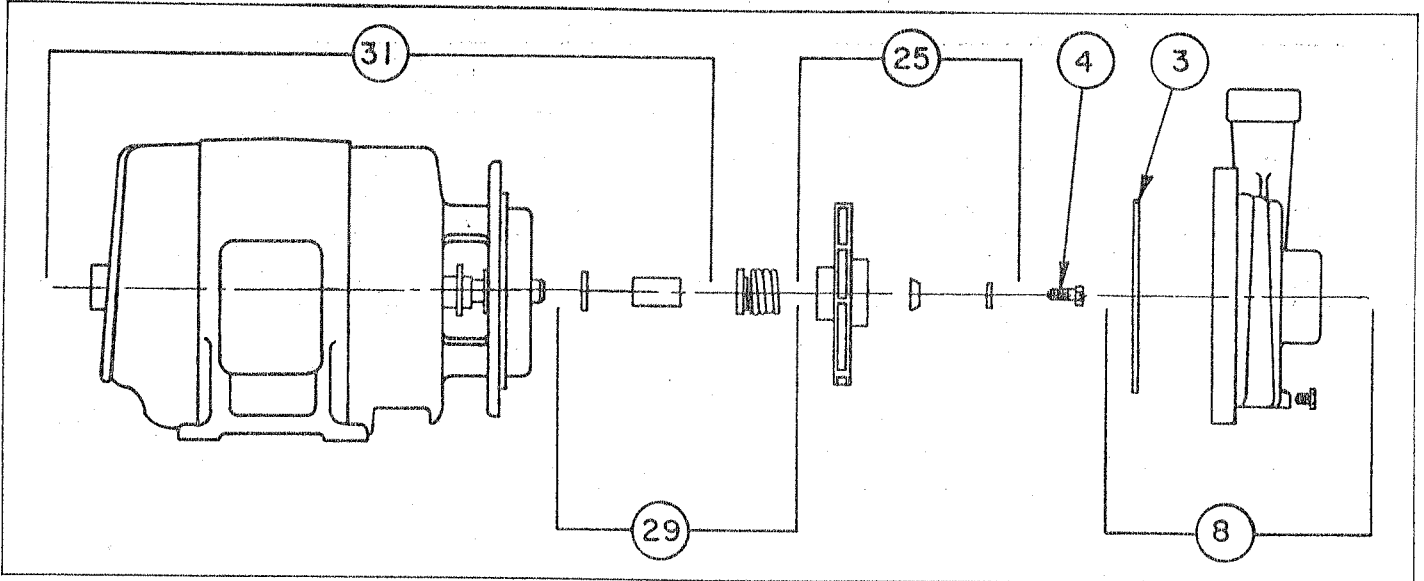

Item	Description	1720		1730	
		Part Number		Part Number	
4	Stainless Steel Cap Screw	3/8-16 x 1		3/8-16 x 1	
8	C.I. Body, Including Plugs and Gasket	170-139RP		170-011RP	
	Bronze Body, including Plugs and Gasket	170-139BRP		170-011BRP	
25	Impeller, including Impeller Washer, Belleville Washer and Gasket	170-137RP		170-017RP	
29	Standard Water Seal, including Impeller Washer Belleville Washer, Sleeve and Gaskets	170-095RP		170-095RP	
	Viton Water Seal including same as above.	170-095VRP		170-095VRP	
3	Gasket	170-022RP		170-022RP	

Motors are not available.

When Ordering, Specify Part Number, Part Name and Complete Model Number of Circulator

TACO, INC.
1160 Cranston Street, Cranston, Rhode Island 02920

Item	Description	1771		1772		1773		1774	
		Part Number		Part Number		Part Number		Part Number	
4	Stainless Steel Cap Screw	3/8-16 x 1		3/8-16 x 1		3/8-16 x 1		3/8-16 x 1	
8	C.I. Body, including Plugs and Gasket	170-139RP		170-139RP		170-139RP		170-139RP	
	Bronze Body, including Plugs and Gasket	170-139BRP		170-139BRP		170-139BRP		170-139BRP	
25	Impeller, including Impeller Washer, Belleville Washer and Gasket	170-061RP		170-061RP		170-061RP		170-061RP	
		170-133RP		170-134RP		170-135RP		170-136RP	
29	Standard Water Seal, including Impeller Washer, Belleville Washer, Sleeve and Gaskets	170-095RP		170-095RP		170-095RP		170-095RP	
	Viton Water Seal, Inc. same as above	170-095VRP		170-095VRP		170-095VRP		170-095VRP	
3	Gasket	170-022RP		170-022RP		170-022RP		170-022RP	

Item	Description	1781		1782		1783		1784	
		Part Number		Part Number		Part Number		Part Number	
4	Stainless Steel Cap Screw	3/8-16 x 1		3/8-16 x 1		3/8-16 x 1		3/8-16 x 1	
8	C.I. Body, including Plugs and Gasket	170-011RP		170-011RP		170-011RP		170-011RP	
	Bronze Body, including Plugs and Gasket	170-011BRP		170-011BRP		170-011BRP		170-011BRP	
25	Impeller, including Impeller Washer, Belleville Washer and Gasket	170-064RP		170-064RP		170-064RP		170-064RP	
				170-065RP		170-066RP		170-140RP	
29	Standard Water Seal, including Impeller Washer, Belleville Washer, Sleeve and Gaskets	170-095RP		170-095RP		170-095RP		170-095RP	
	Viton Water Seal, includes same as above.	170-095VRP		170-095VRP		170-095VRP		170-095VRP	
3	Gasket	170-022RP		170-022RP		170-022RP		170-022RP	

